

The dimensions (in inches) of the bridge and neck position Vibetron pickups are provided in the drawings below (all dimensions are in inches). The pickups are 0.755" tall.

Bridge position pickup:

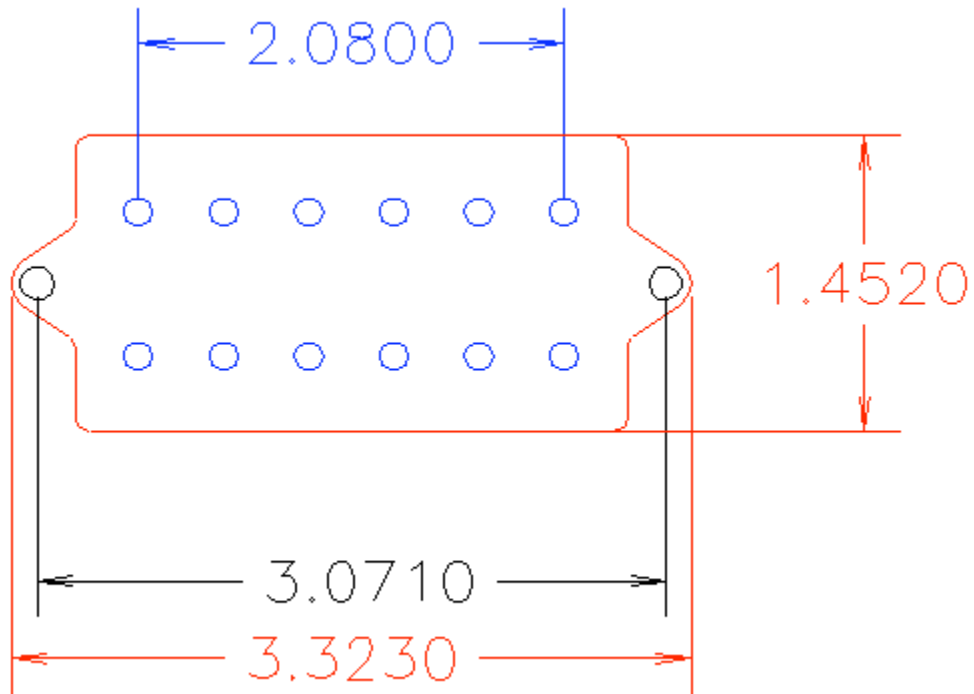

Neck position pickup:

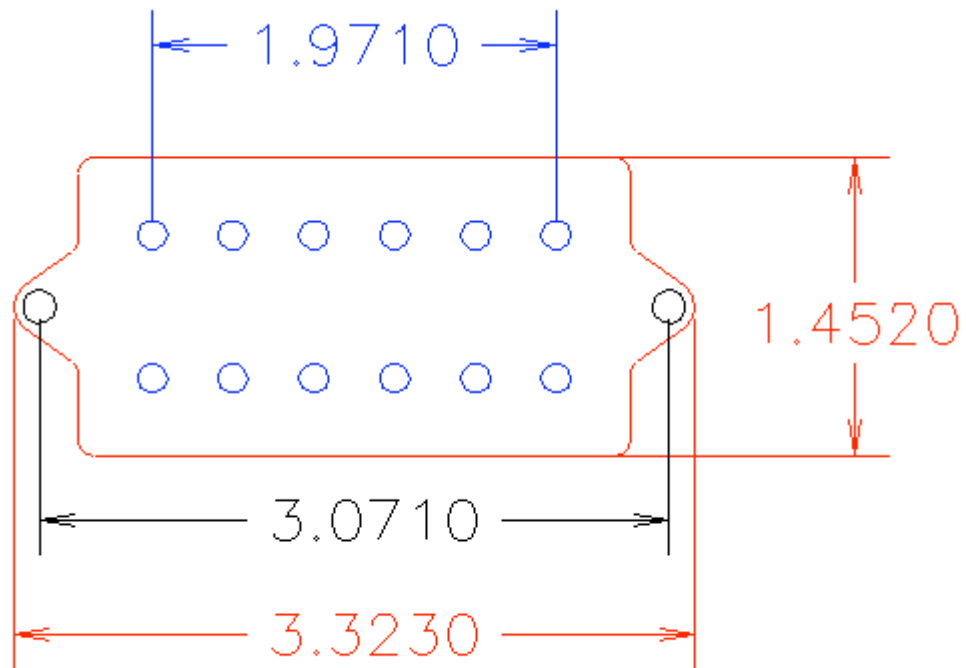

Pete Biltoft
Vintage Vibe Guitars
www.vintagevibeguitars.com
(541) 436-2836

All Rights Reserved